

UZ/UZK

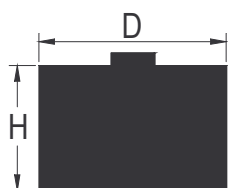

D mm \ H mm	200	230	250	280	300	320	360	400	440	540
65	•	•	•	•	•	•	•	•	•	•
100	•	•	•	•	•	•	•	•	•	•
150	•	•	•	•	•	•	•	•	•	•
200	•	•	•	•	•	•	•	•	•	
250	•	•	•	•	•	•	•	•	•	
280									•	
300						•	•	•	•	
350							•	•	•	
380									•	

UR

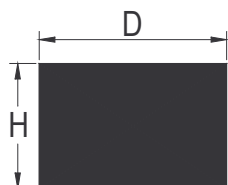
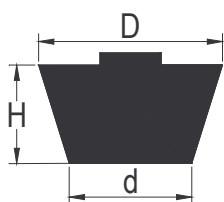

N°	H mm	D mm	d mm
R 0950	490	325	240
R 1105	490	300	235
R 1405	600	350	260
R 758	615	350	260
R 760	635	350	260

Su tutti i supporti il nottolino è alto 10 mm con diam. di 90 mm

AF



Anelli di rialzo
su richiesta

UKKB

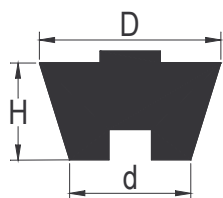

N°	H mm	D mm	d mm
UKKB 1025	100	250	180
UKKB 1225	120	250	180
UKKB 1525	150	250	180
UKKB 2025	200	250	180
UKKB 1030	100	300	180
UKKB 1230	120	300	180
UKKB 1530	150	300	180
UKKB 1830	350	300	180
UKKB 2030	200	300	180

Altre dimensioni
a richiesta

GR



Canali di colata
a disegno